

GAIN AND OFFSET ADJUSTMENTS SEALED (CODE 'Y')

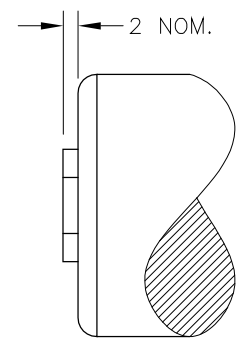

*HOUSING BORE TO SUIT PROBE: $\phi 20.10$ TO $\phi 20.15$ (§ 16.7% TO 11.4% SQUEEZE WITH 16x2.4 O-RING). RETAIN PROBE WITH GRUB SCREW.

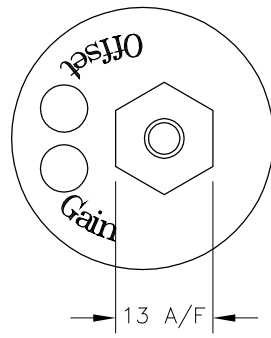
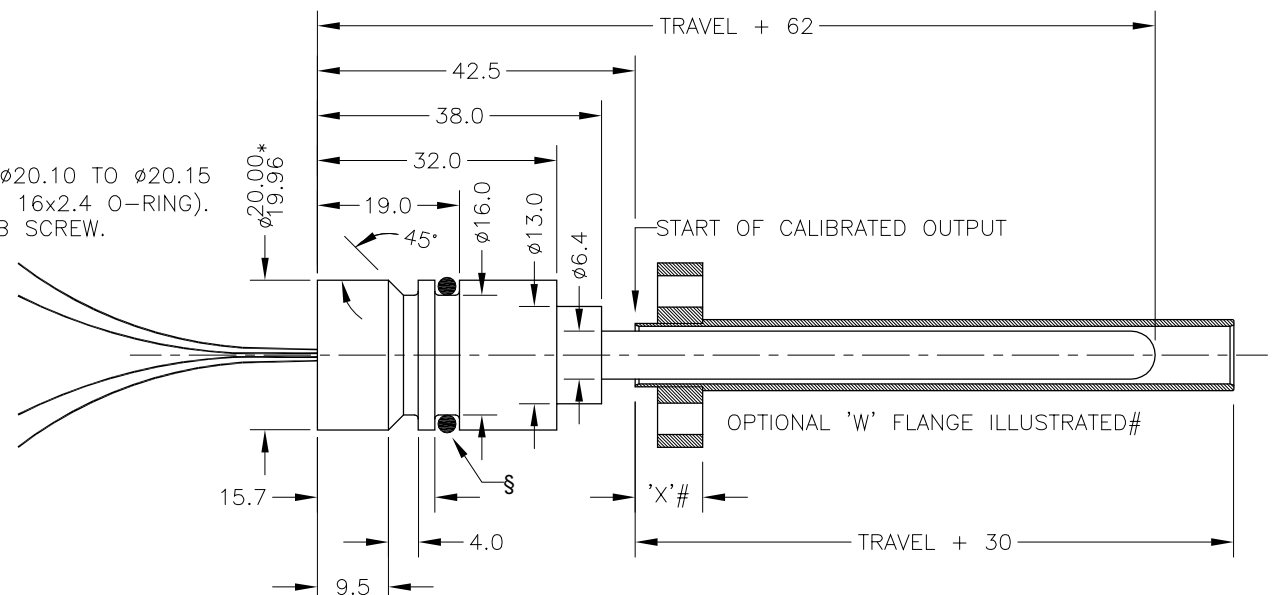
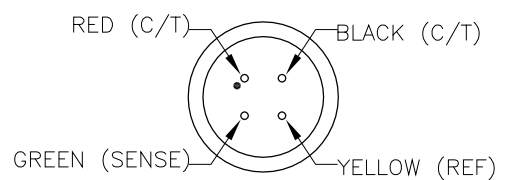

ELECTRICAL OPTIONS/ SPECIFICATIONS

OUTPUT	SUPPLY	
0.5 TO 4.5V RATIOMETRIC	5V	
SUPPLY CURRENT 12mA TYP. 20mA MAX.		
CABLE: 0.2mm ² , O/A SCREEN, PUR JACKET - SUPPLIED WITH 50cm OR REQUIRED LENGTH IN cm (15000cm MAX).		
STANDARD 3-CORE: JACKET $\phi 4$ mm BLACK	e.g. L50	
OPTIONAL 5-CORE: JACKET $\phi 4.6$ mm BLUE	e.g. LQ50	
CABLE/CONNECTOR* CONNECTIONS;		
3 CORE	5 CORE	CONNECTOR
RED	RED	:1 +Ve
-	ORG	:1 +SENSE (5-WIRE ONLY)
BLACK	BLACK	:3 0V
-	GRY	:3 -SENSE (5-WIRE ONLY)
WHITE	WHITE	:2 OUTPUT
SCREEN	SCREEN	:4 BODY

*CONNECTORS; MAXIMUM CONDUCTOR CROSS SECTION 0.75mm²
RANGE OF DISPLACEMENT FROM 0-5mm TO 0-800mm e.g.76, IN INCREMENTS OF 1mm.

BODY TUBE/PROBE HOUSING MATERIAL: STAINLESS STEEL.
35 A/F BASE MATERIAL: STAINLESS STEEL (CODE 'P')
FLANGE MATERIAL: STAINLESS STEEL (CODE 'T')

FURTHER OPTIONS:
SEE DRAWING TG24-11 FOR #OPTIONAL FLANGE DETAILS AND ORDERING INFORMATION.

TARGET TUBE:
STAINLESS STEEL 316 $\phi 9.45$ OPTION 'R'
SEE P100-12 FOR DETAILS TYPICAL TARGET TUBE MOUNTING ARRANGEMENTS

NOTE:- READ INSTALLATION SHEET X106-19 FOR FULL INSTRUCTIONS FOR USE.

ATEX / IECEx APPROVED TO

Ex II 1G

Ex ia IIC T4 Ga (Ta= -40° to +80°C)

Ui 11.4V, li 0.2A, Pi 0.51W

APPROVED FOR USE IN CONJUNCTION WITH A GALVANICALLY ISOLATED BARRIER.

NOTE: APPROVAL ONLY APPLIES AT NORMAL ATMOSPHERIC PRESSURE!

CONNECTIONS BETWEEN PROBE AND ELECTRONICS MODULE: FOUR WIRES; RED, BLACK, GREEN AND YELLOW, LENGTH: 300, CROSS SECTION: 0.25mm², WIRES POTTED IN PROBE HOUSING. INTERCONNECTIONS MUST BE PROTECTED FROM WATER INGRESS AND STRAIN RELIEVED.

G	ADDITIONAL DIMS/VIEWS ADDED.	PDM
H	APPROVAL STANDARDS UPDATED - RAN465.	PDM
J	OPTION 'S' REMOVED - RAN1035.	PDM
K	RANGE WAS 50-600mm RAN1056	RDS
L	TARGET NOTES AMENDED ~ RAN1114	PDM
M	5-CORE OPTION ADDED ~ RAN1102	PDM
N	RANGE NOTE AMENDED ~ RAN1200	PDM



DRAWINGS NOT TO BE CHANGED WITHOUT REFERENCE TO THE CHANGE PROCEDURE. CHANGES TO PARTS USED IN INTRINSICALLY SAFE PRODUCT MUST BE APPROVED BY THE AUTHORISED PERSON. THIS IS AN UNCONTROLLED PRINT AND WILL NOT BE UPDATED.



G	05/07/11		CHECKED BY	X	± 0.4
H	10/03/14		RDS	X.X	± 0.2
J	29/06/15			X.XX	± 0.1
					DIMS mm
K	9/11/15	DESCRIPTION			
L	18/10/16	X106 IS INT'NAL MOUNTED			
M	11/04/17	CYLINDER SENSOR WITH			
N	30/08/17	EXTERNAL ELECTRONICS			
SCALE		DRAWING NUMBER		X106-11	REV N
10mm					SHEET 1 OF 1